

09/08/99

CONTRACT: TIP PROJECT: 36059.160, R-5788EA, R-5788EB

STATE OF NORTH CAROLINA
DIVISION OF HIGHWAYS

CHATHAM & RANDOLPH

LOCATION: I-73 / I-74 REST AREA, ASHEBORO, LIBERTY, RANDLEMAN, & SILER CITY

TYPE OF WORK: INSTALL CONCRETE CURB RAMP, REPAIR PAVEMENT, CURB & GUTTER AND SIDEWALK

STATE	STATE PROJECT REFERENCE NO.	SHEET NO.	TOTAL SHEETS
N.C.	R-5788EA, R-5788EB	1	
STATE PROJ. NO.	F.A. PROJ. NO.	DESCRIPTION	
36059.160		CONST.	
R-5788EA			
44918.3.6	TAP-0801 (017)	CONST.	
R-5788EB			
44918.3.7	TAP-0801 (019)	CONST.	

INDEX OF SHEETS

SHEET NUMBER	SHEET
1	TITLE SHEET, INDEX OF SHEETS
2	PAVER AND PAVEMENT REPAIR DETAILS
2-A THRU 2-C	CURB RAMP DETAILS
3	SUMMARY OF QUANTITIES
4 THRU 5	REST AREA PLAN SHEETS
6 THRU 9	VICINITY MAPS
10 THRU 34	PLAN SHEETS

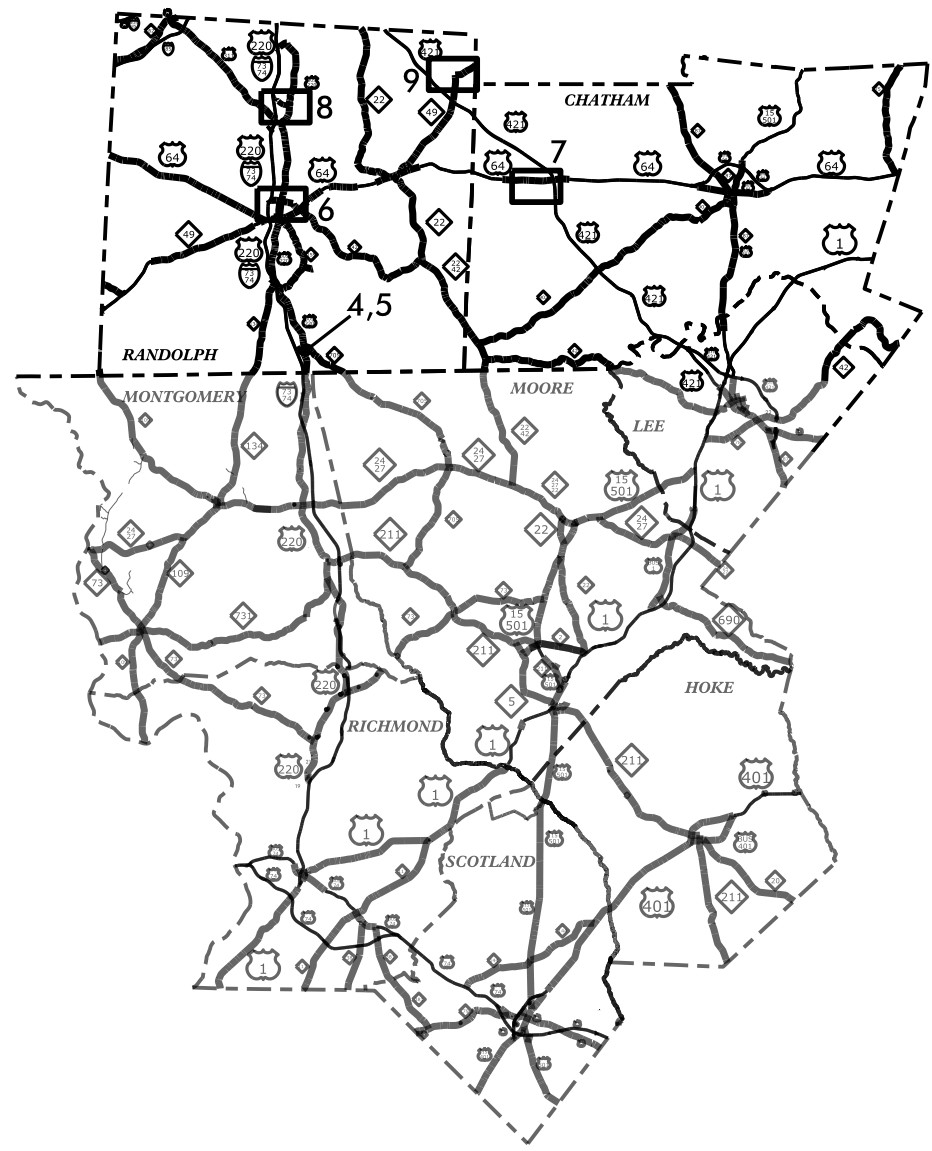

DOCUMENT NOT CONSIDERED FINAL
UNLESS ALL SIGNATURES COMPLETED

GRAPHIC SCALES

NTS

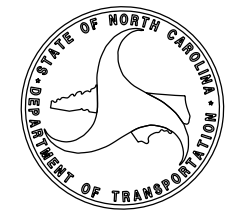

PROJECT LENGTH
VARIOUS INTERSECTIONS

Prepared in the Office of:
DIVISION OF HIGHWAYS
DIVISION 8 - DDC UNIT

2018 STANDARD SPECIFICATIONS

RIGHT OF WAY DATE:

LETTING DATE:

HYDRAULICS ENGINEER

SIGNATURE: _____ P.E.

DIVISION DESIGN ENGINEER

10/16/2018

DocuSigned by:
Greg S. Davis
SIGNATURE: _____ P.E.

DIVISION DESIGN ENGINEER



16-OCT-2018 10:32
Z:\r\dy\div8\sidewalk_intersection_ramps_2019\R-5788EA_EB...tsh.dgn
AT DIV8-304810
gsdavis

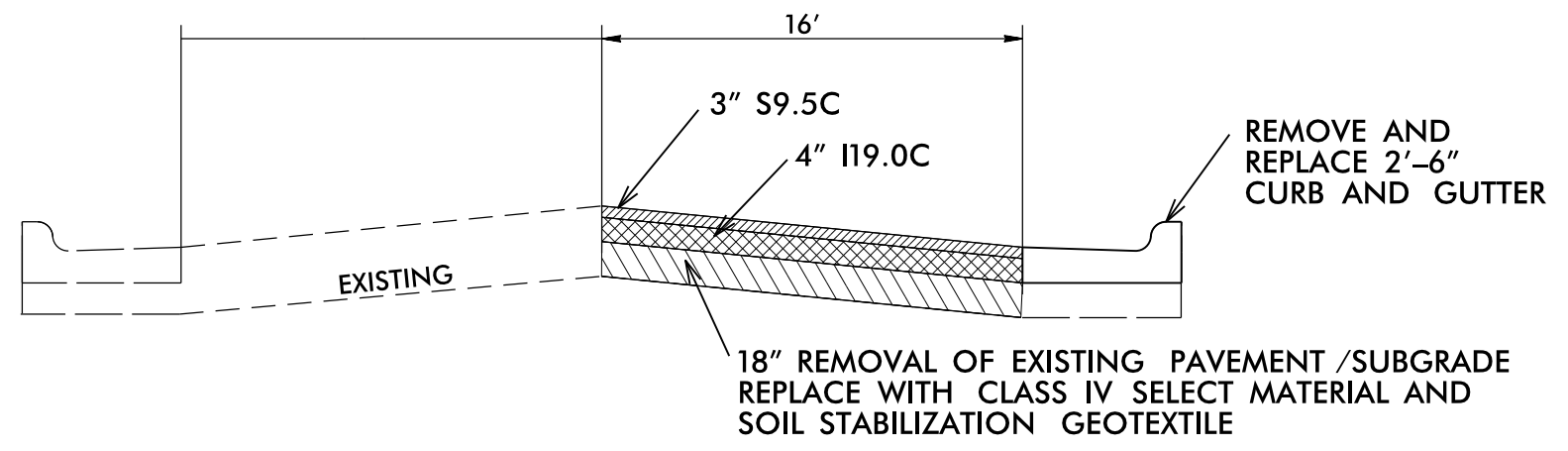

PAVEMENT REPAIR DETAIL

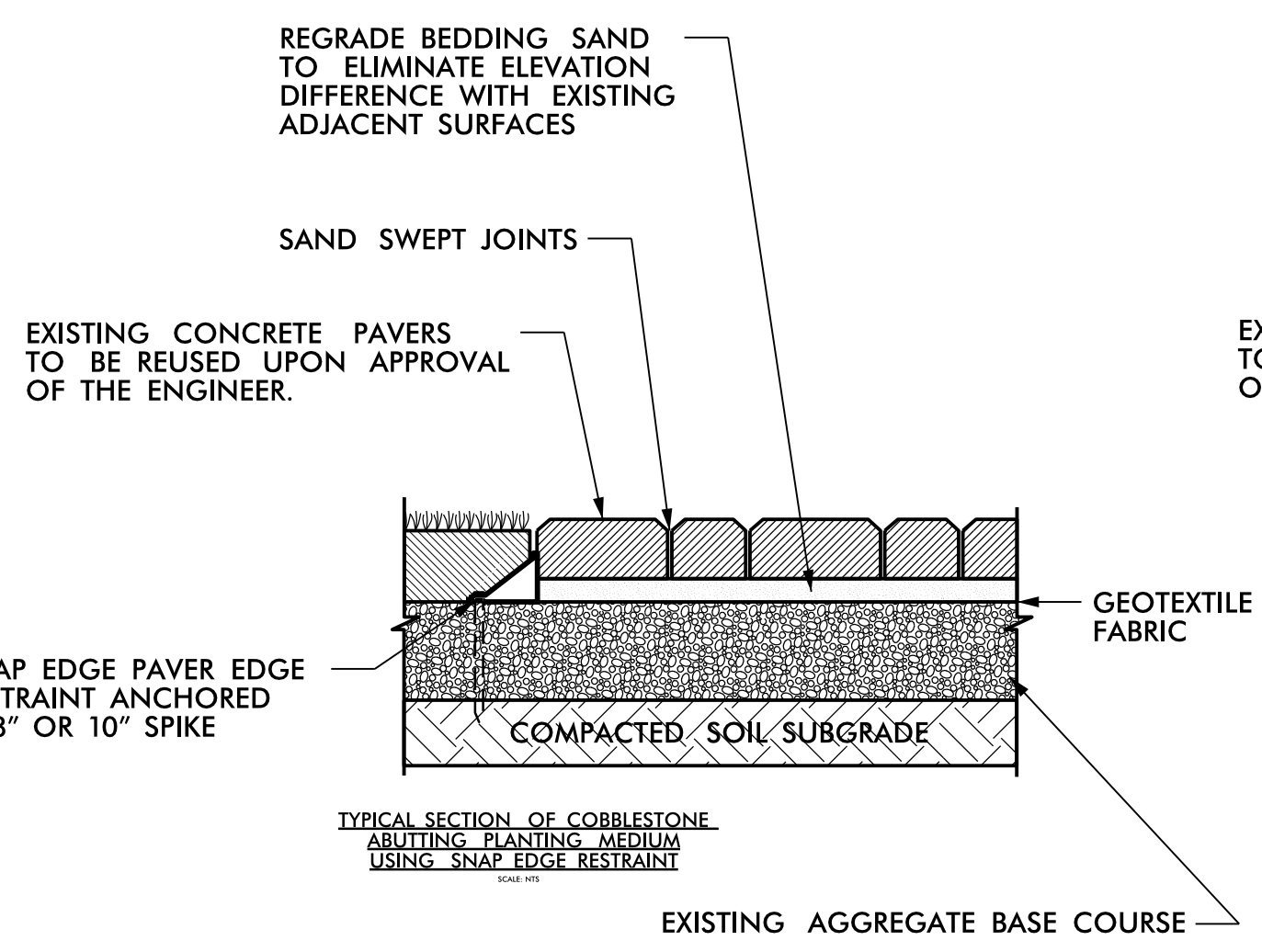

TYPICAL SECTION OF COBBLESTONE
ABUTTING PLANTING MEDIUM
USING SNAP EDGE RESTRAINT
SCALE: NTS

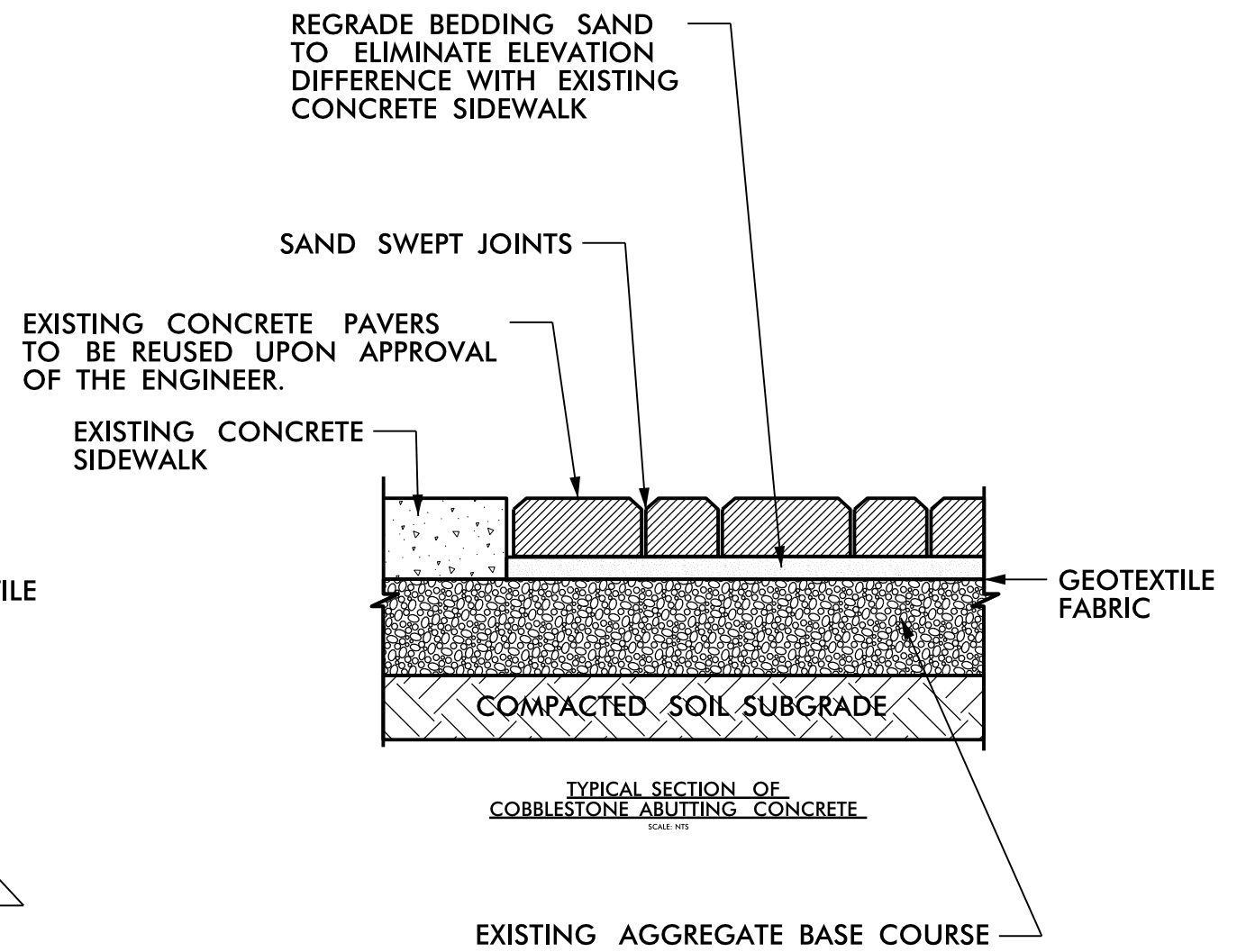

TYPICAL SECTION OF
COBBLESTONE ABUTTING CONCRETE
SCALE: NTS

COBBLESTONE PAVER REPAIR DETAIL

REVISIONS

16-OCT-2018, jll
2:\dj\div\sidewalk\intersection_ramps_2019\FestAreaWork\South_Bound_Rest_Area.dgn
8/17/99

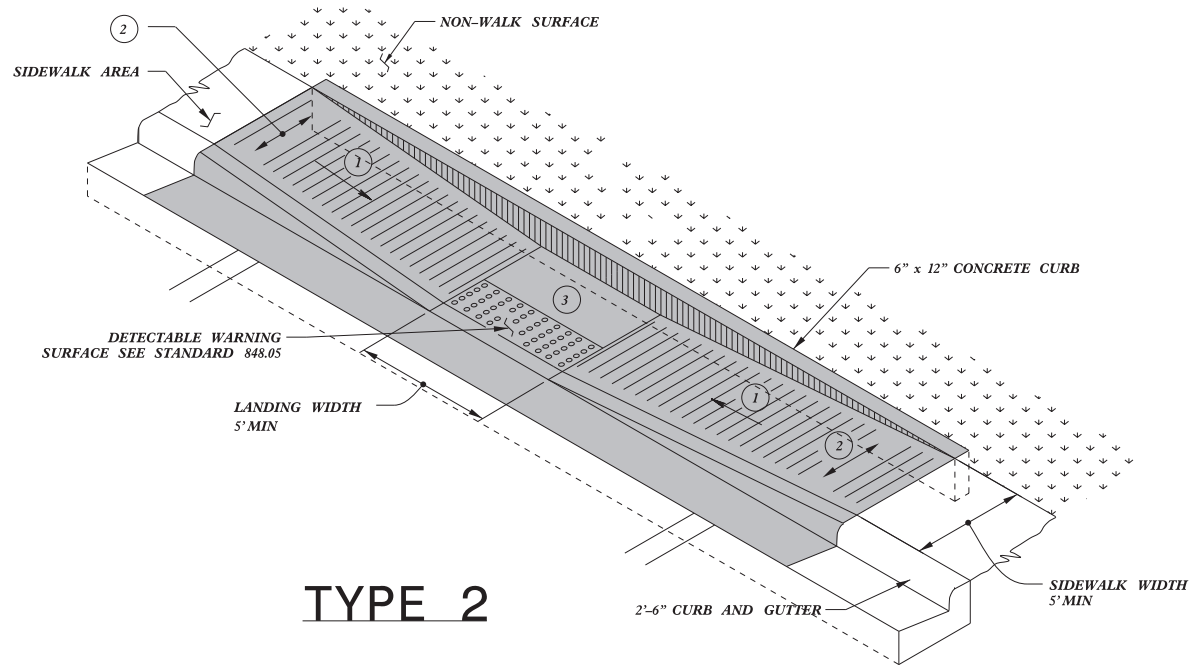

TYPE 2

PAY LIMITS FOR 1 CURB RAMP

- 1 8.33% (12:1) MAX RAMP SLOPE
- 2 CROSS SLOPE: 2.00%
- 3 CURB RAMPS REQUIRE A (4'-0") MINIMUM LANDING WITH A MAXIMUM CROSS SLOPE AND LONGITUDINAL SLOPE OF 2.00% WHERE PEDESTRIANS PERFORM TURNING MANEUVERS. SLOPE TO DRAIN TO CURB.

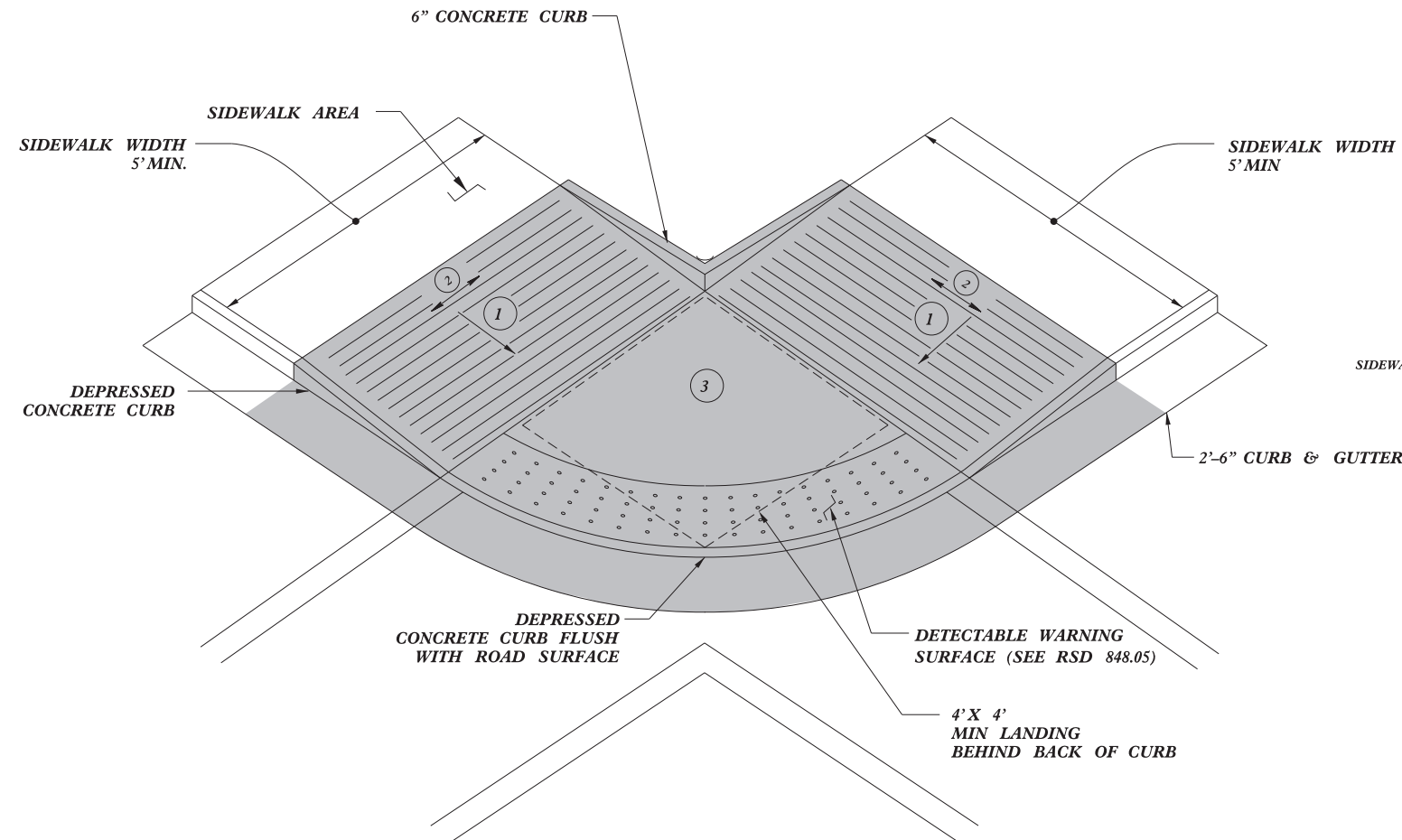

TYPE 2A

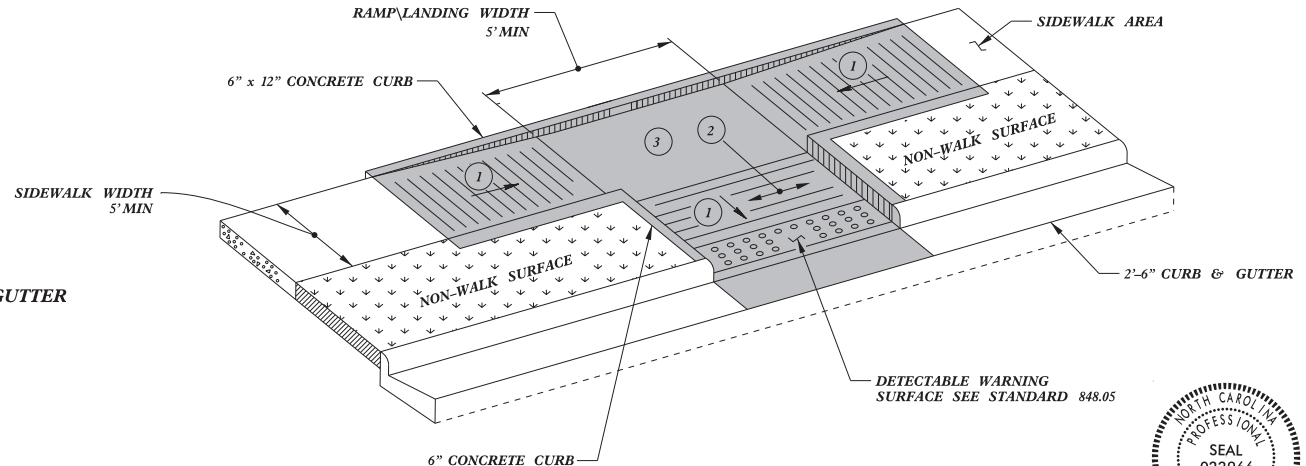

TYPE 3



DocuSigned by:
Joel S. Howerton
10/16/2018
873F3D17DCC45F...

DOCUMENT NOT CONSIDERED FINAL
UNLESS ALL SIGNATURES COMPLETED

**CONTRACT STANDARDS
AND DEVELOPMENT UNIT**
Office 919-707-6950 FAX 919-250-4119

CURB RAMPS
Parallel Ramps

ORIGINAL BY: J.S. HOWERTON DATE: 7/7/11
MODIFIED BY: DATE:
CHECKED BY: DATE:
FILE SPEC.: stds/2012CurbRamp/CurbRampDetails.dgn

REFER TO ROADWAY STANDARD DRAWING NUMBER 848.05 SHEET 3 OF 3 FOR ALL RAMP NOTES

5/14/99
SYTIME/CN/US/NAME/

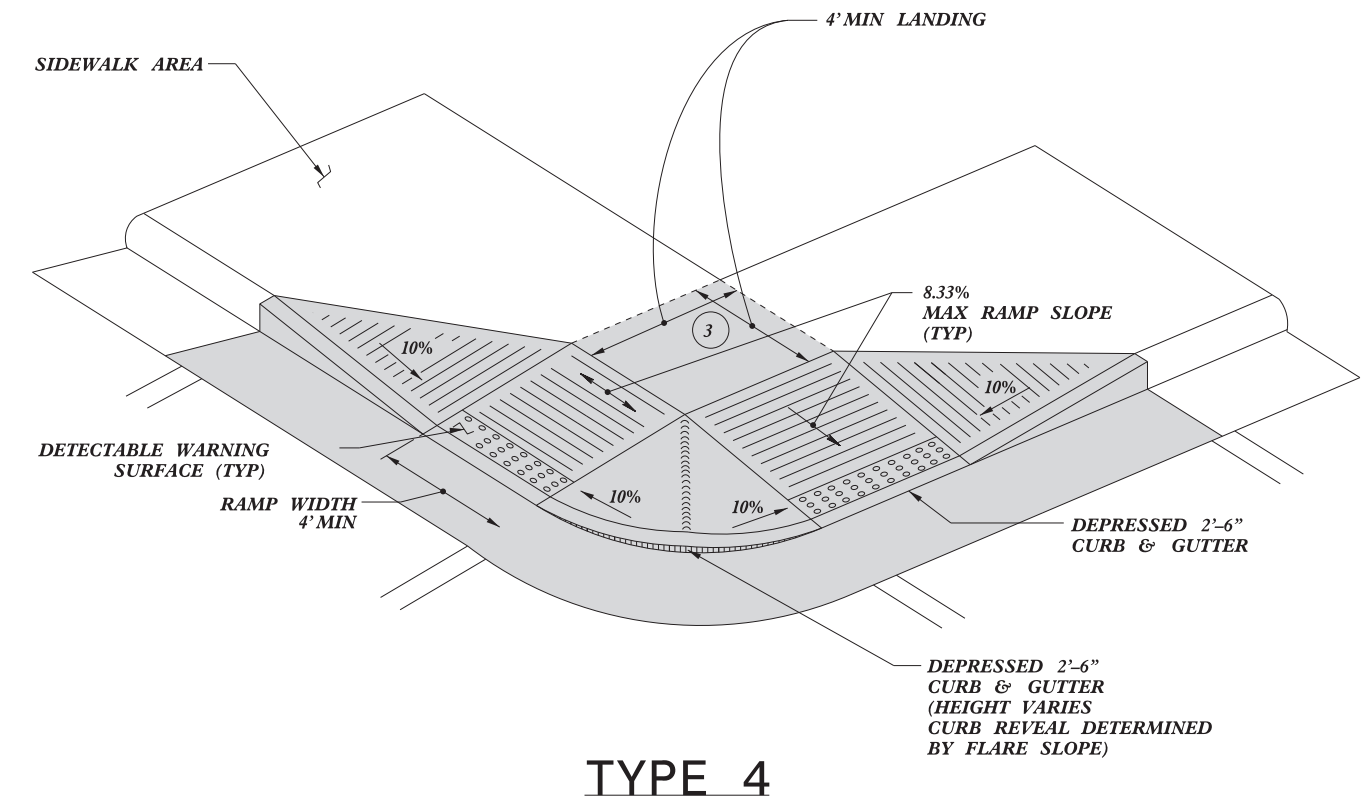

TYPE 4

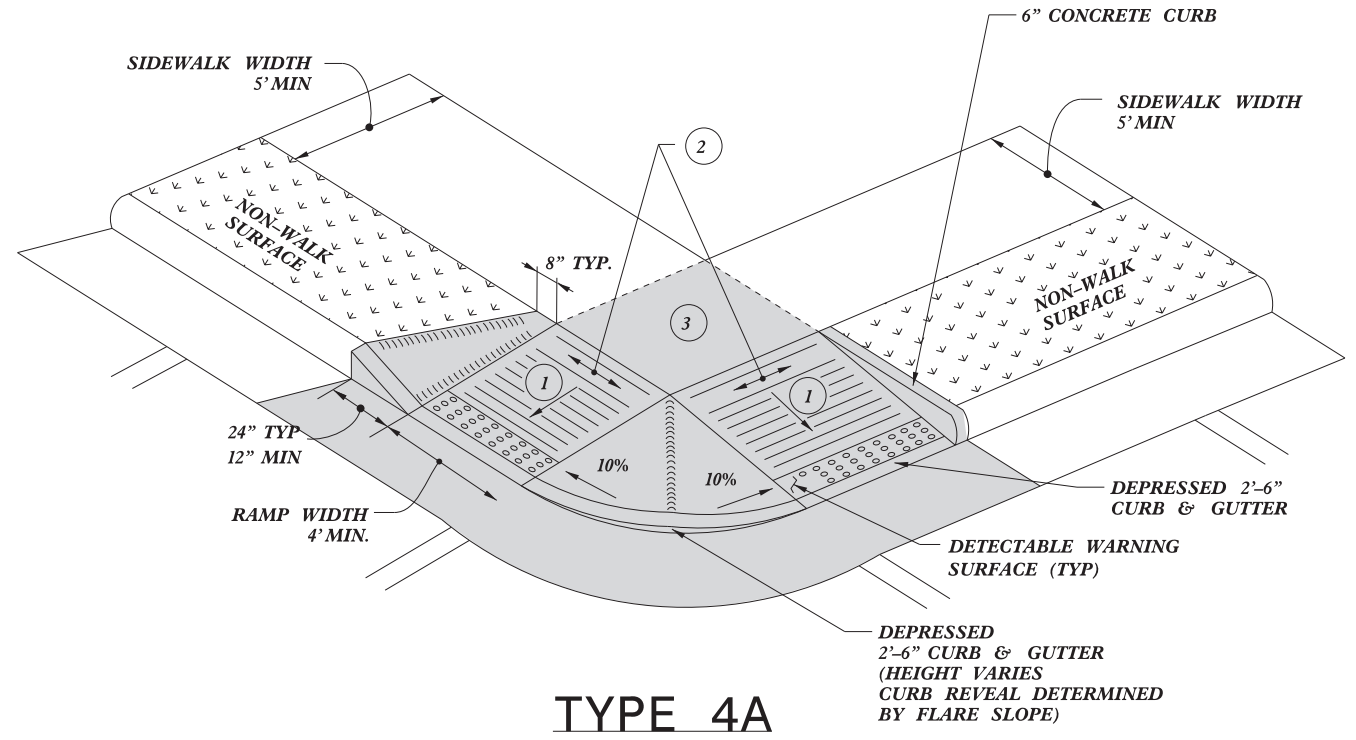

TYPE 4A

PAY LIMITS FOR 2 CURB RAMPS

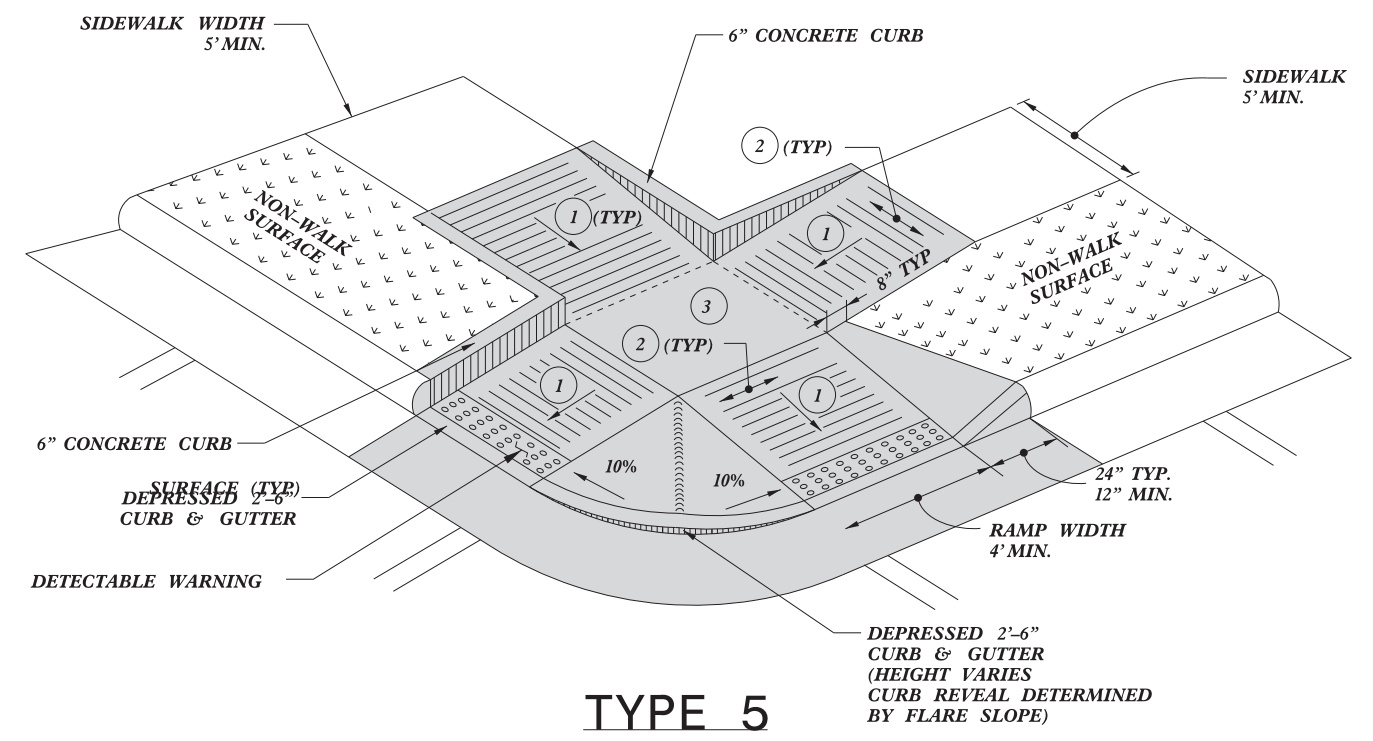

TYPE 5

- 1 8.33% (12:1) MAX RAMP SLOPE
- 2 CROSS SLOPE: 2.00%
- 3 CURB RAMPS REQUIRE A (4'-0") MINIMUM LANDING WITH A MAXIMUM CROSS SLOPE AND LONGITUDINAL SLOPE OF 2.00% WHERE PEDESTRIANS PERFORM TURNING MANEUVERS. SLOPE TO DRAIN TO CURB.



DocuSigned by:
J. S. Howerton
10/16/2018
073F3D17DCDC45F
DOCUMENT NOT CONSIDERED FINAL UNLESS ALL SIGNATURES COMPLETED

CONTRACT STANDARDS AND DEVELOPMENT UNIT Office 919-707-6950 FAX 919-250-4119	
CURB RAMPS Shared Landing	
ORIGINAL BY: J.S. HOWERTON	DATE: 7/7/11
MODIFIED BY:	DATE:
CHECKED BY:	DATE:
FILE SPEC: .stds/2012CurbRamp/CurbRampDetails.dgn	

5/14/99
SYTIME
V
CGN
J
DU
SERNAME
S
S

PROJECT NO.	SHEET NO.	TOTAL NO.
36059.160, R-5788EA R-5788EB,	3	

SUMMARY OF QUANTITIES

PROJECT NO	COUNTY	MAP NO	ROUTE	DESCRIPTION	0156000000-E	0163000000-E	0196000000-E	1099500000-E	1099700000-E	1503000000-E	1523000000-E	1575000000-E	2549000000-E	2591000000-E	2600000000-N	2605000000-N	2738000000-E	4457000000-N	6982000000-E
					REMOVAL OF EXISTING ASPHALT PAVEMENT	REMOVAL OF EXISTING CONCRETE PAVEMENT	GEOTEXTILE FOR SOIL STABILIZATION	SHALLOW UNDERCUT	CLASS IV SUBGRADE STABILIZATION	INTERMEDIATE COURSE, 119.0C	SURFACE COURSE, S9.5C	ASPHALT BINDER FOR PLANT MIX	2'-6" CURB & GUTTER	4" CONCRETE SIDEWALK	RETROFIT EXISTING CURB RAMP	CONCRETE CURB RAMP	GENERIC PAVING ITEM - REMOVE AND REPLACE ASPHALT PAVEMENT	TEMPORARY TRAFFIC CONTROL	GENERIC LANDSCAPING ITEM- REPAIR COBBELSTONE PAVERS
					SY	SY	SY	CY	TON	TONS	TONS	TONS	LF	SY	EA	EA	SY	LS	SF
36059.160		1	SOUTH BOUND REST AREA	SOUTH BOUND I-74, MM 60	150	24	150	90	150	34	25	3	175	24					20.00
TOTAL FOR MAP NO. 1					150	24	150	90	150	34	25	3	175	24					20.00
36059.160		2	NORTH BOUND REST AREA	NORTH BOUND I-74, MM 60		12								12				*	
TOTAL FOR MAP NO. 2						12								12					
TOTAL FOR PROJ NO. 36059.160					150	36	150	90	150	34	25	3	175	36				1	20.00
44918.3.6 (R-5788EA)	Randolph	3	SR 2344 (E. PRESNELL ST.)	INTERSECTION W/ FARR ST.											3				
TOTAL FOR MAP NO. 3															3				
44918.3.6 (R-5788EA)	Randolph	4	SR 1451 (S. PARK ST.)	INTERSECTION W/ W. KIVETT ST.												4	35.00		
TOTAL FOR MAP NO. 4																4	35.00		
44918.3.6 (R-5788EA)	Randolph	5	SR 1451 (S PARK ST.)	INTERSECTION W/ COOPER ST.												2			
TOTAL FOR MAP NO. 5																2			
44918.3.6 (R-5788EA)	Randolph	6	SR 2203 (CLIFF RD.)	INTERSECTION W/ REDDING RD.									15		2				
TOTAL FOR MAP NO. 6													15		2				
44918.3.6 (R-5788EA)	Randolph	7	SR 2327 (S COX ST.)	INTERSECTION W/ WORTH ST.											3	1	8.00		
TOTAL FOR MAP NO. 7															3	1	8.00		*
TOTAL FOR PROJ NO. R-5788EA														15	6	9	43.00	1	
44918.3.7 (R-5788EB)	Chatham	8	SR 1108 (N. CHATHAM AVE.)	INTERSECTION W/ CRAVEN ST.												2	16.00		
TOTAL FOR MAP NO. 8																2	16.00		
44918.3.7 (R-5788EB)	Chatham	9	SR 1108 (N CHATHAM AVE.)	INTERSECTION W/ CHARLES ST.									20			2	16.00		
TOTAL FOR MAP NO. 9													20			2	16.00		
44918.3.7 (R-5788EB)	Chatham	10	SR 1006 (N 2ND AVE.)	INTERSECTION W/ SR 1107 (E 3RD ST.)											5	1	8.00		
TOTAL FOR MAP NO. 10															5	1	8.00		
44918.3.7 (R-5788EB)	Randolph	11	US HWY 220 BUS (S. MAIN ST.)	INTERSECTION W/ S COBLE ST.												2	16.00		
TOTAL FOR MAP NO. 11																2	16.00		
44918.3.7 (R-5788EB)	Randolph	12	US HWY 220 BUS (S. MAIN ST.)	INTERSECTION W/ SPENCER ST.												2	16.00		
TOTAL FOR MAP NO. 12																2	16.00		
44918.3.7 (R-5788EB)	Randolph	13	US HWY 220 BUS (S. MAIN ST.)	INTERSECTION W/ E BROWN ST.												4	35.00		
TOTAL FOR MAP NO. 13																4	35.00		
44918.3.7 (R-5788EB)	Randolph	14	US HWY 220 BUS (S. MAIN ST.)	INTERSECTION W/ CHURCH ST.												2	8.00		
TOTAL FOR MAP NO. 14																2	8.00		
44918.3.7 (R-5788EB)	Randolph	15	US HWY 220 BUS (S. MAIN ST.)	INTERSECTION W/ SR 1952 (HIGH POINT ST.)											4				
TOTAL FOR MAP NO. 15															4				
44918.3.7 (R-5788EB)	Randolph	16	US HWY 220 BUS (S. MAIN ST.)	INTERSECTION W/ E&W RIVER DR.											4	4			
TOTAL FOR MAP NO. 16															4	4			
44918.3.7 (R-5788EB)	Randolph	17	US HWY 220 BUS (S. MAIN ST.)	INTERSECTION W/ E & W NAOMI ST.											2				
TOTAL FOR MAP NO. 17															2				
44918.3.7 (R-5788EB)	Randolph	18	SR 1006 (S. GREENSBORO ST.)	INTERSECTION W/ E BROWER AVE											1	1			
TOTAL FOR MAP NO. 18															1	1			
44918.3.7 (R-5788EB)	Randolph	19	NC 49 (S. FAYETTEVILLE ST)	INTERSECTION W/ W BROWER AVE												2	16.00		
TOTAL FOR MAP NO. 19																2	16.00		
44918.3.7 (R-5788EB)	Randolph	20	NC 49 (S. FAYETTEVILLE ST.)	INTERSECTION W/ SR 1006 (S. GREENSBORO ST.)												2			
TOTAL FOR MAP NO. 20																2			
44918.3.7 (R-5788EB)	Randolph	21	NC 49 (S. FAYETTEVILLE ST.)	INTERSECTION W/ E RALEIGH AVE											2	2			
TOTAL FOR MAP NO. 21															2	2			
44918.3.7 (R-5788EB)	Randolph	22	SR 1006 (N. GREENSBORO ST.)	INTERSECTION W/ W STARMOUNT AVE												2			
TOTAL FOR MAP NO. 22																2			
44918.3.7 (R-5788EB)	Randolph	23	SR 1006 (N. GREENSBORO ST.)	INTERSECTION W/ W HIGHFALL AVE												2			
TOTAL FOR MAP NO. 23																2			
44918.3.7 (R-5788EB)	Randolph	24	SR 1006 (N. GREENSBORO ST.)	INTERSECTION W/ W BOWMAN AVE												2			
TOTAL FOR MAP NO. 24																2			
44918.3.7 (R-5788EB)	Randolph	25	SR 1006 (N. GREENSBORO ST.)	INTERSECTION W/ E LUTHER AVE												2			
TOTAL FOR MAP NO. 25																2			
44918.3.7 (R-5788EB)	Randolph	26	NC 49 (S. FAYETTEVILLE ST.)	INTERSECTION W/ W DAMERON AVE												2			
TOTAL FOR MAP NO. 26																2			
44918.3.7 (R-5788EB)	Randolph	27	NC 49 (S. FAYETTEVILLE ST.)	INTERSECTION W/ W PATTERSON AVE												2			
TOTAL FOR MAP NO. 27																2			
44918.3.7 (R-5788EB)	Randolph	28	NC 49 (S. FAYETTEVILLE ST.)	INTERSECTION W/ W LEWIS AVE												2			
TOTAL FOR MAP NO. 28																2			*
TOTAL FOR PROJ NO. R-5788EB													20		26	32	131.00	1	
GRAND TOTAL					150	36	150	90	150	34	25	3	195	51	32	41	174.00	1	20.00

PROJECT REFERENCE NO.	SHEET NO.
36059.160	4
RW SHEET NO.	

RANDOLPH COUNTY
SOUTH BOUND REST AREA

PAVEMENT REPAIR
(SEE SHEET 2)
AS DIRECTED BY
THE ENGINEER

REMOVE AND REPLACE
2'-6" CURB AND GUTTER
AS DIRECTED BY
THE ENGINEER

REPLACE SIDEWALK AS
DIRECTED BY
THE ENGINEER

REPAIR COBBLESTONE PAVER
(SEE SHEET 2)
AS DIRECTED
BY THE ENGINEER

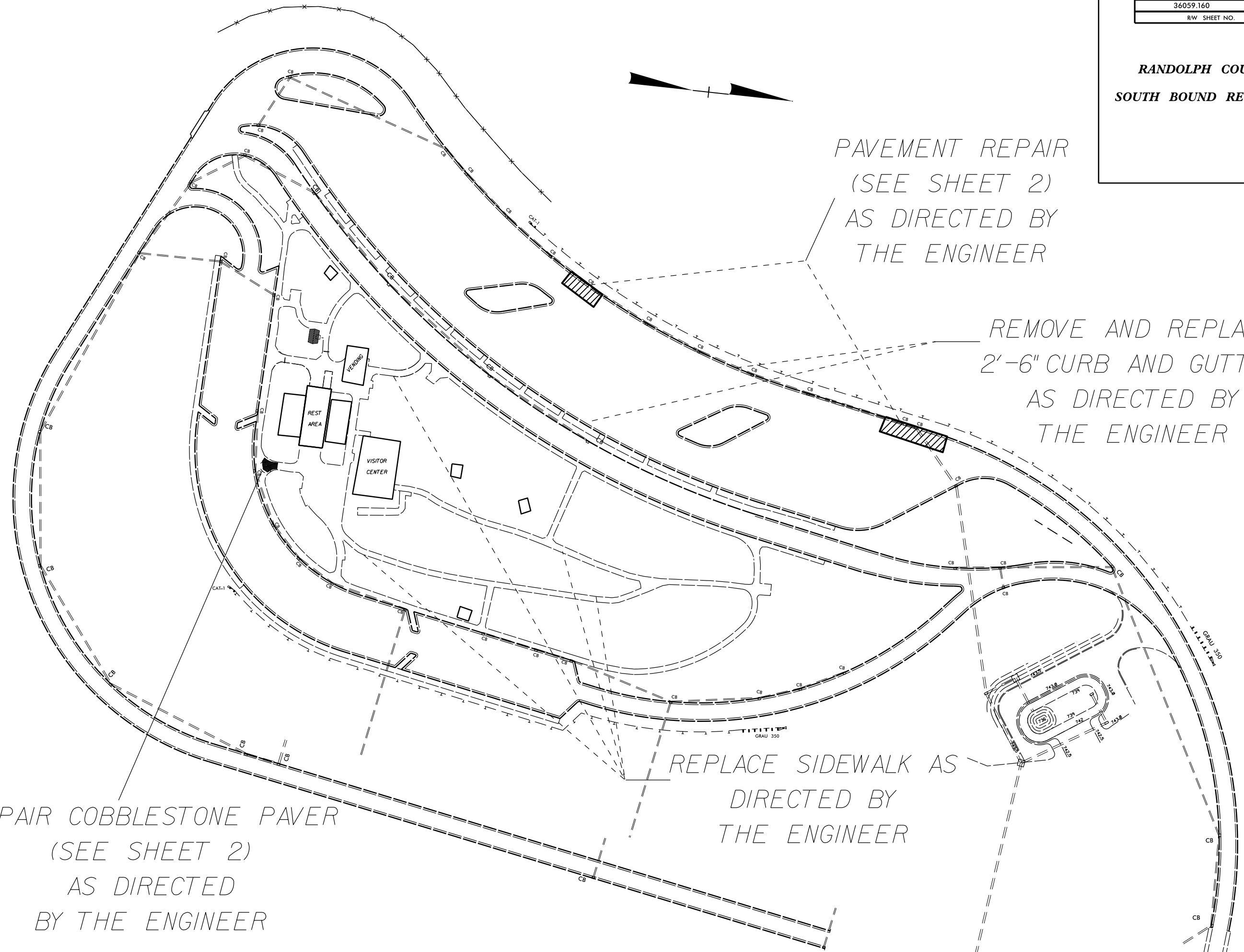

REVISIONS

16-OCT-2018 11:11
Z:\vdg\div\sidewalk_intersection_ramps_2019\restAreaWork\South Bound Rest Area.dgn
8/17/99

PROJECT REFERENCE NO.	SHEET NO.
36059.160	5
RW SHEET NO.	

**RANDOLPH COUNTY
NORTH BOUND REST AREA**

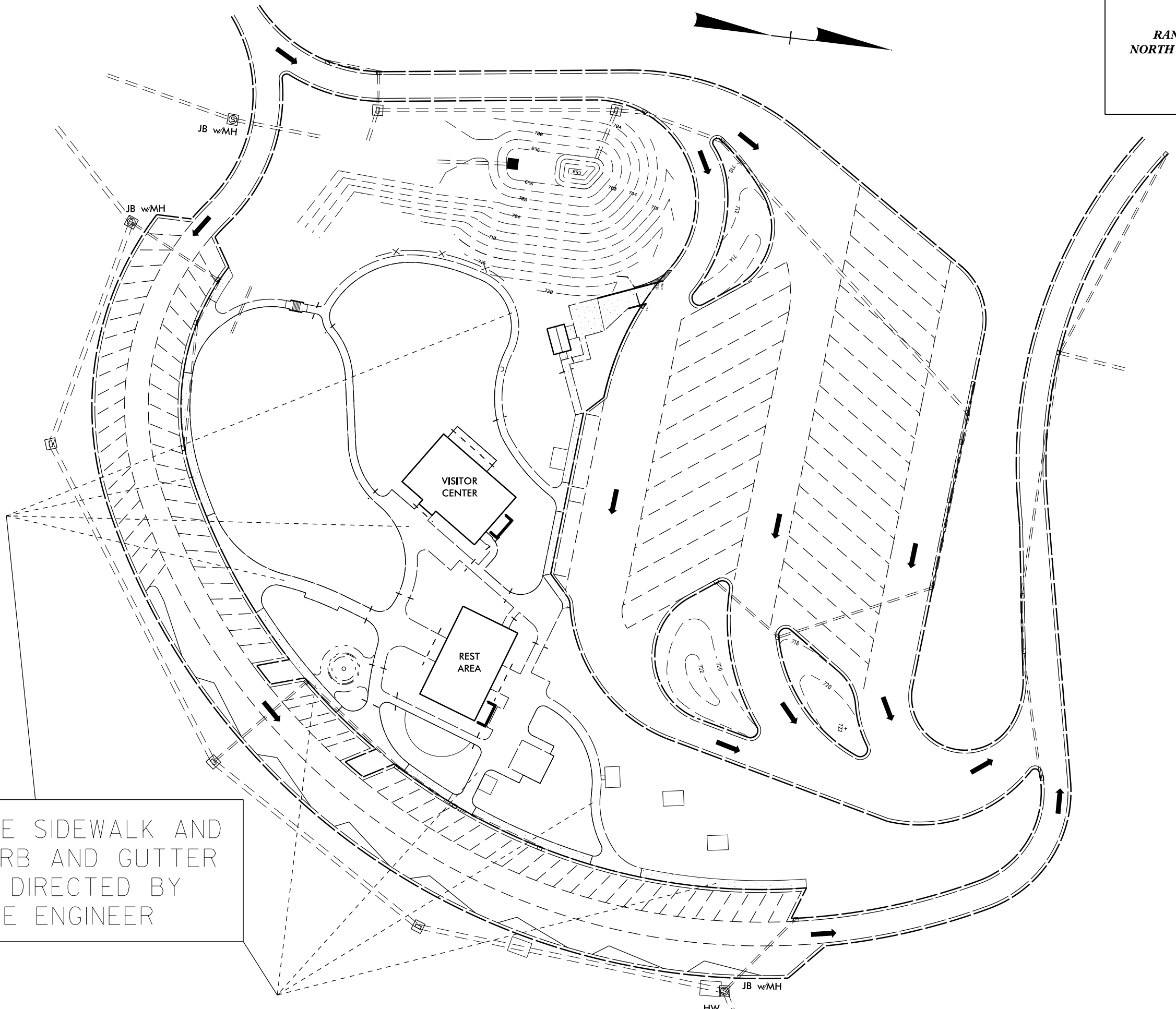

REPLACE SIDEWALK AND
2'6" CURB AND GUTTER
AS DIRECTED BY
THE ENGINEER

REVISIONS

16-OCT-2018 10:39
Z:\rdg\div8\sidewalk\intersection_ramps_2019\restAreaWork\North_Bound_Rest_Area.dgn
8/17/99

PROJECT LOCATION MAP

RANDOLPH COUNTY

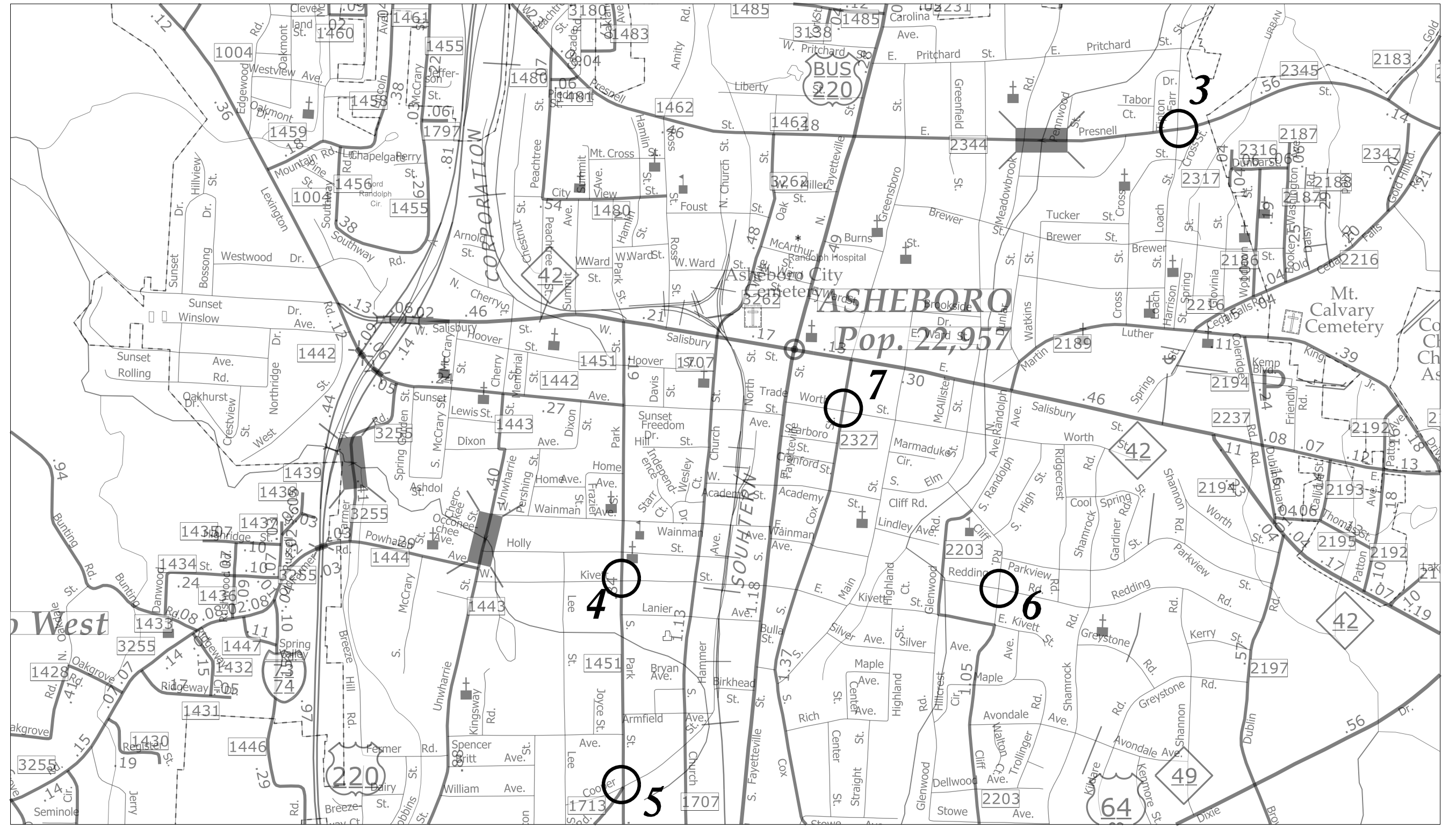

REVISIONS

16-OCT-2018 10:33
 2:17:41
 8/17/99
 19-01-2018 10:33
 2:17:41
 8/17/99
 19-01-2018 10:33
 2:17:41
 8/17/99

PROJECT LOCATION MAP

RANDOLPH COUNTY

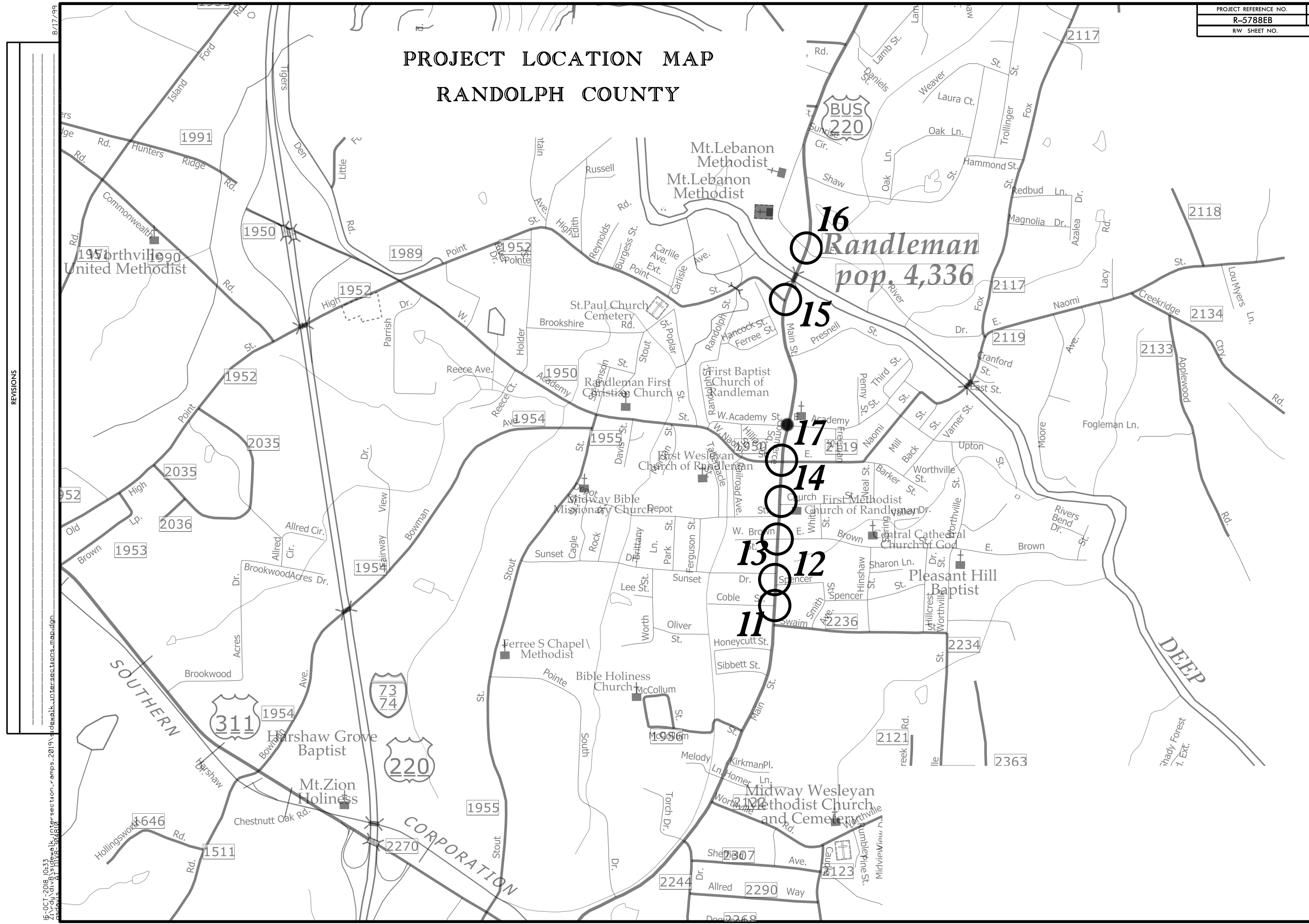

REVISIONS

16-OCT-2018, 10:33
 2:17-dg\div8\sd\p\16-01-section_ramps-2019\sidewalk_intersections_map.dgn
 8/17/99

PROJECT LOCATION MAP

RANDOLPH COUNTY

8/17/99
16-OCT-2018 10:33 AM
2: V:\dg\div\815\sd\vol\19\intersections_ramps-2019_sidewalk_intersections_map.dgn
REVISED BY: [unreadable]

REVISIONS

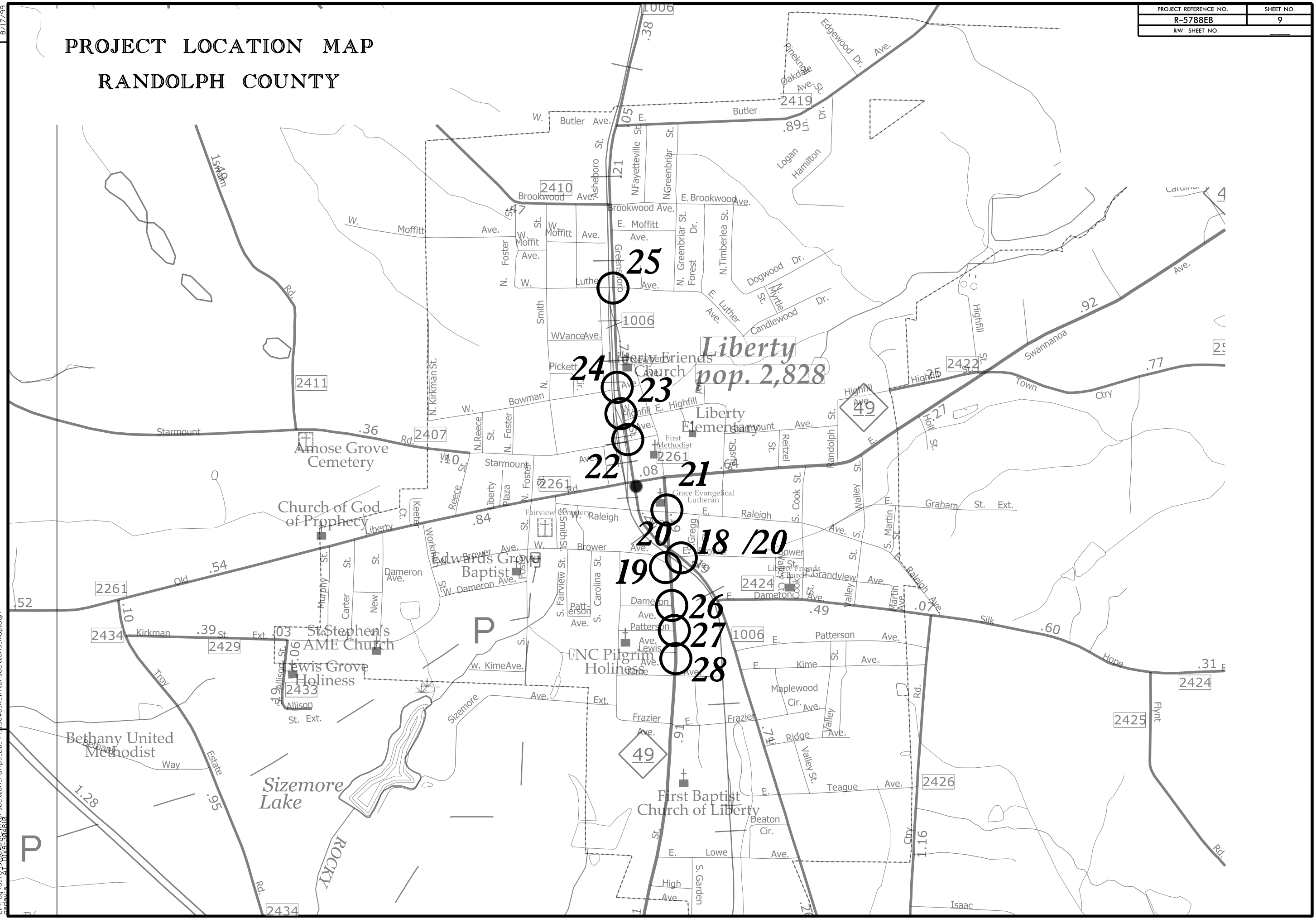

Liberty
pop. 2,828

- 25
- 24
- 23
- 22
- 21
- 20
- 19
- 18
- 20
- 26
- 27
- 28

PROJECT REFERENCE NO.	SHEET NO.
R-5788EA	10
RW SHEET NO.	

MAP #3



Farr St.

SR 2344 (E. Presnell St.)

RETROFIT EXISTING CURB RAMP.

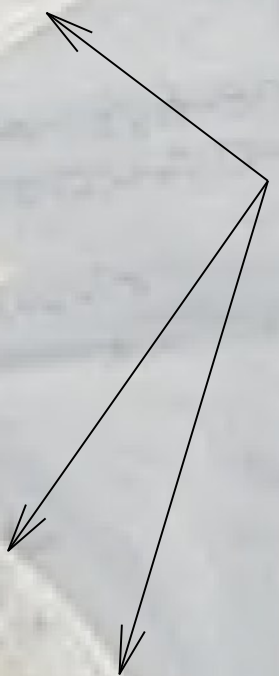

REVISIONS

16-OCT-2018 10:36
Z:\dj\div8\sidewalk\intersection_ramps_2019\sidewalk_int.psh\sidewalk_int-03.dgn
8/17/99



PROJECT REFERENCE NO.	SHEET NO.
R-5788EA	11
RW SHEET NO.	

MAP #4



Kivett St.

SR 1451 (S. Park St.)

SAWCUT & REMOVE ASPHALT PAVEMENT TO CONSTRUCT NEW CURB RAMP. REPLACE ASPHALT AS NEEDED TO PROVIDE POSITIVE DRAINAGE.

WCR

WCR

WCR

WCR

REVISIONS

16-OCT-2018 10:37
 Z:\vdj\div8\sidewalk\intersection_ramps_2019\sidewalk_int.psh\sidewalk_int-04.dgn
 8/17/99

PROJECT REFERENCE NO.	SHEET NO.
R-5788EA	12
RW SHEET NO.	

MAP #5



NEW CURB RAMP

Cooper St.

SR 1451 (S. PARK ST.)

WCR

WCR

REVISIONS

16-OCT-2018 10:37
 z:\dj\div8\sidewalk\intersection_ramps_2019\sidewalk_int.psh\sidewalk_int_05.dgn

8/17/99

PROJECT REFERENCE NO.	SHEET NO.
R-5788EA	13
RW SHEET NO.	

MAP #6



EXTEND SIDEWALK 10 FEET

Redding Rd.

NEW CURB RAMP

SR 2203 (Cliff Rd.)

WCR

WCR

REVISIONS

16-OCT-2018 10:37
 Z:\p\d\div\sidewalk\intersection_ramps_2019\sidewalk_int.psh\sidewalk_int_06.dgn
 8/17/99

MAP #7



SAWCUT & REMOVE ASPHALT PAVEMENT TO CONSTRUCT NEW CURB RAMP. REPLACE ASPHALT AS NEEDED TO PROVIDE POSITIVE DRAINAGE.

RETROFIT EXISTING CURB RAMP.

RETROFIT EXISTING CURB RAMP.

RETROFIT EXISTING CURB RAMP.

WCR

Worth St.

SR 2327
(S. COX ST.)

REVISIONS

8/17/99

16-OCT-2018 10:37
Z:\vd\div8\sidewalk\intersection_ramps_2019\sidewalk_int.psh\sidewalk_int-07.dgn



PROJECT REFERENCE NO.	SHEET NO.
R-5788EB	15
RW SHEET NO.	

MAP #8

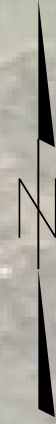

SAWCUT & REMOVE ASPHALT PAVEMENT TO CONSTRUCT NEW CURB RAMP. REPLACE ASPHALT AS NEEDED TO PROVIDE POSITIVE DRAINAGE.

WCR

WCR

SR 1108 (N. Chatham Ave.)

Craven St.

MAP #9

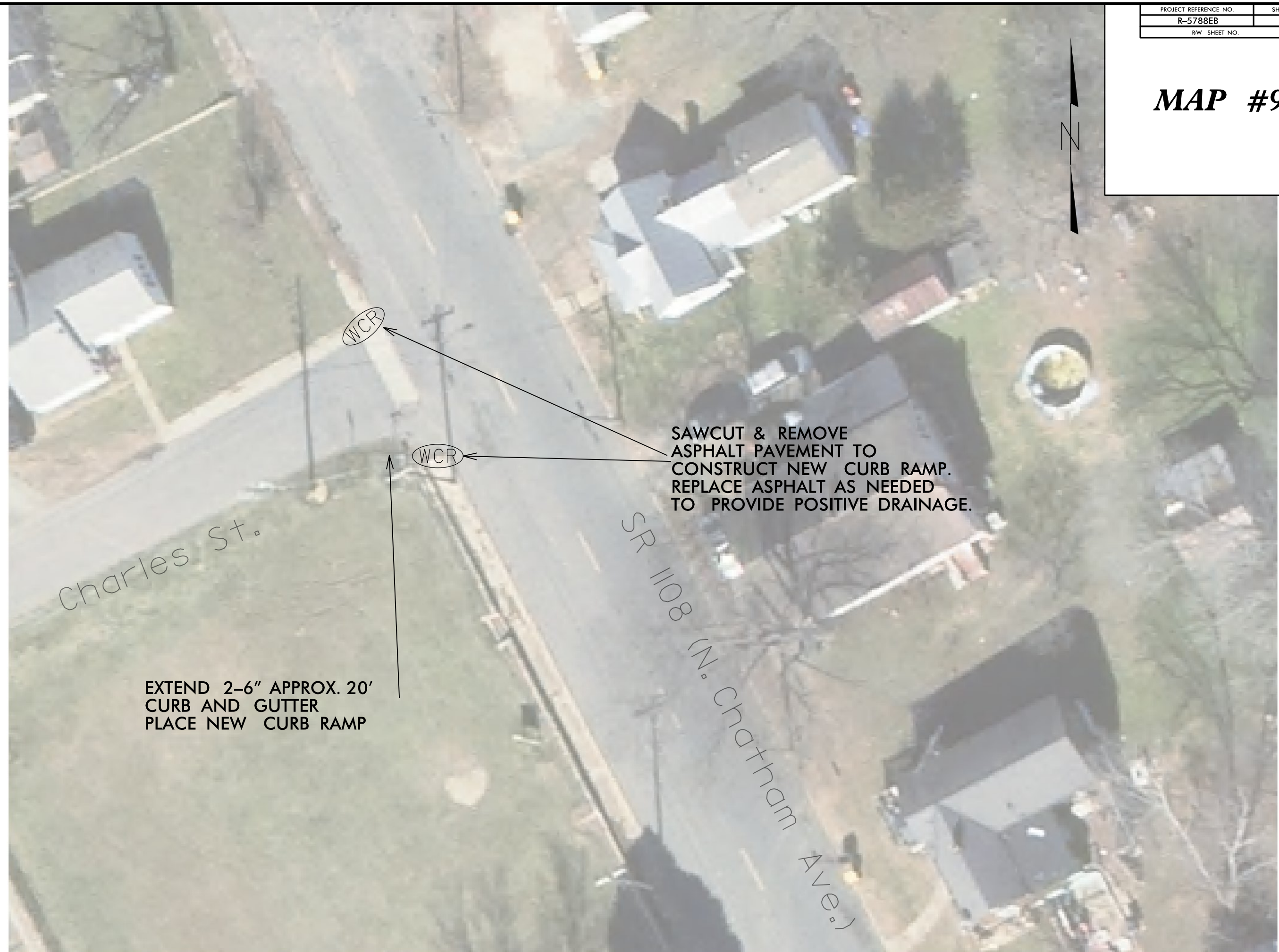
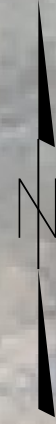

Charles St.

SR 1108 (N. Chatham Ave.)

WCR

WCR

SAWCUT & REMOVE ASPHALT PAVEMENT TO CONSTRUCT NEW CURB RAMP. REPLACE ASPHALT AS NEEDED TO PROVIDE POSITIVE DRAINAGE.

EXTEND 2-6" APPROX. 20' CURB AND GUTTER PLACE NEW CURB RAMP

MAP #10

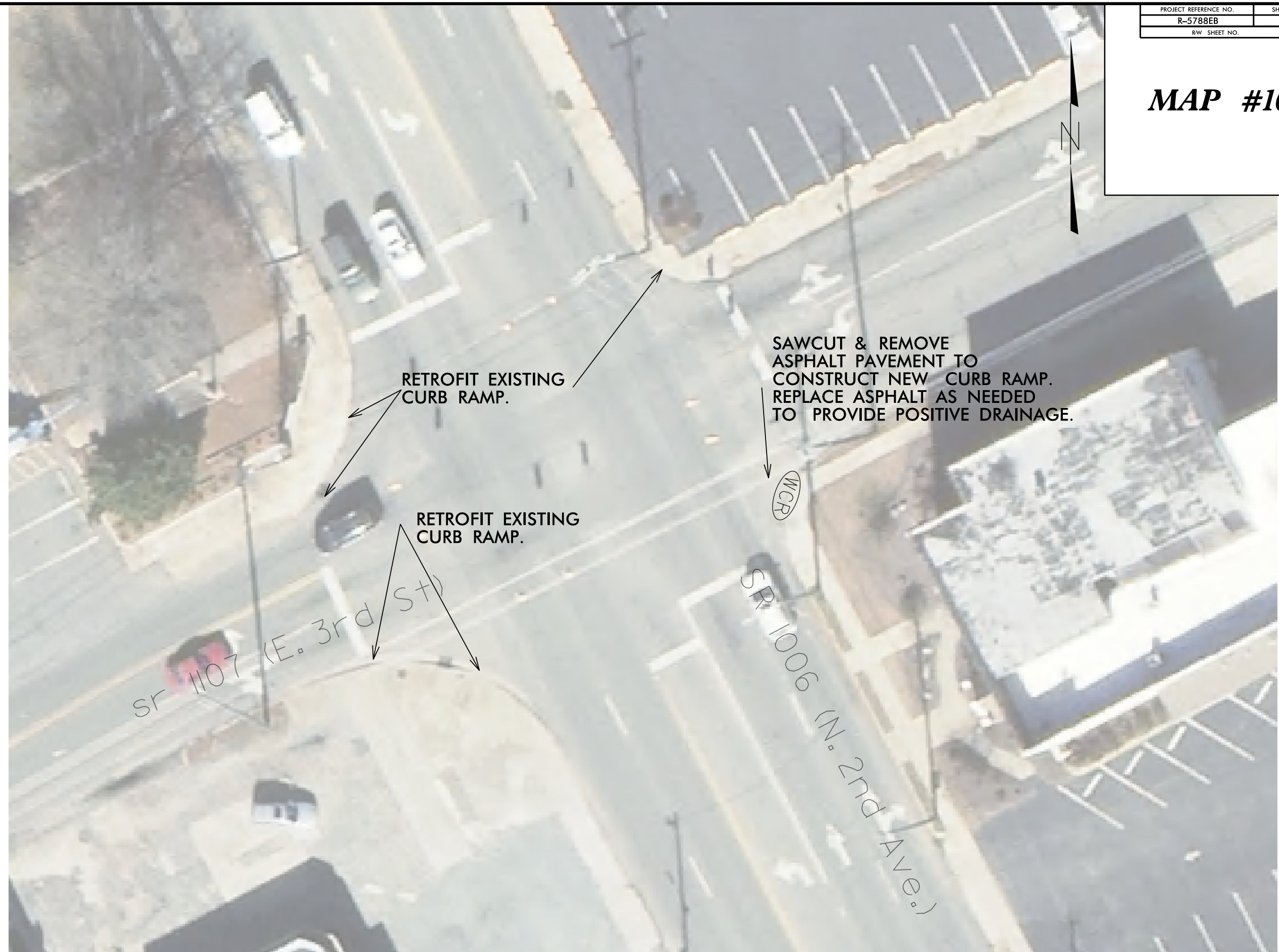

RETROFIT EXISTING CURB RAMP.

SAWCUT & REMOVE ASPHALT PAVEMENT TO CONSTRUCT NEW CURB RAMP. REPLACE ASPHALT AS NEEDED TO PROVIDE POSITIVE DRAINAGE.

RETROFIT EXISTING CURB RAMP.

SR 1107 (E. 3rd St)

SR 1006 (N. 2nd Ave.)

MCR

MAP #11



SAWCUT & REMOVE
ASPHALT PAVEMENT TO
CONSTRUCT NEW CURB RAMP.
REPLACE ASPHALT AS NEEDED
TO PROVIDE POSITIVE DRAINAGE.

Coble St.

US 220 Bus. (S. Main St.)

WCR

WCR

MAP #12



US 220 BUS. (S. Main St.)

Spencer St.

SAWCUT & REMOVE ASPHALT PAVEMENT TO CONSTRUCT NEW CURB RAMP. REPLACE ASPHALT AS NEEDED TO PROVIDE POSITIVE DRAINAGE.

WCR

WCR

MAP #13



US 220 BUS.
(S. Main St.)

E. Brown St.

SAWCUT & REMOVE
ASPHALT PAVEMENT TO
CONSTRUCT NEW CURB RAMP.
REPLACE ASPHALT AS NEEDED
TO PROVIDE POSITIVE DRAINAGE.

WCR

WCR

WCR

WCR

MAP #14

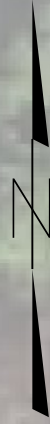

SAWCUT & REMOVE ASPHALT PAVEMENT TO CONSTRUCT NEW CURB RAMP. REPLACE ASPHALT AS NEEDED TO PROVIDE POSITIVE DRAINAGE.



US 220 BUS. (S. Main St.)

Church St.

WCR

PROJECT REFERENCE NO.	SHEET NO.
R-5788EB	22
RW SHEET NO.	

MAP #15



16-OCT-2018 10:38
Z:\p\div\sidewalk\intersection_ramps_2019\sidewalk_int.psh\sidewalk_int-15.dgn

MAP #16

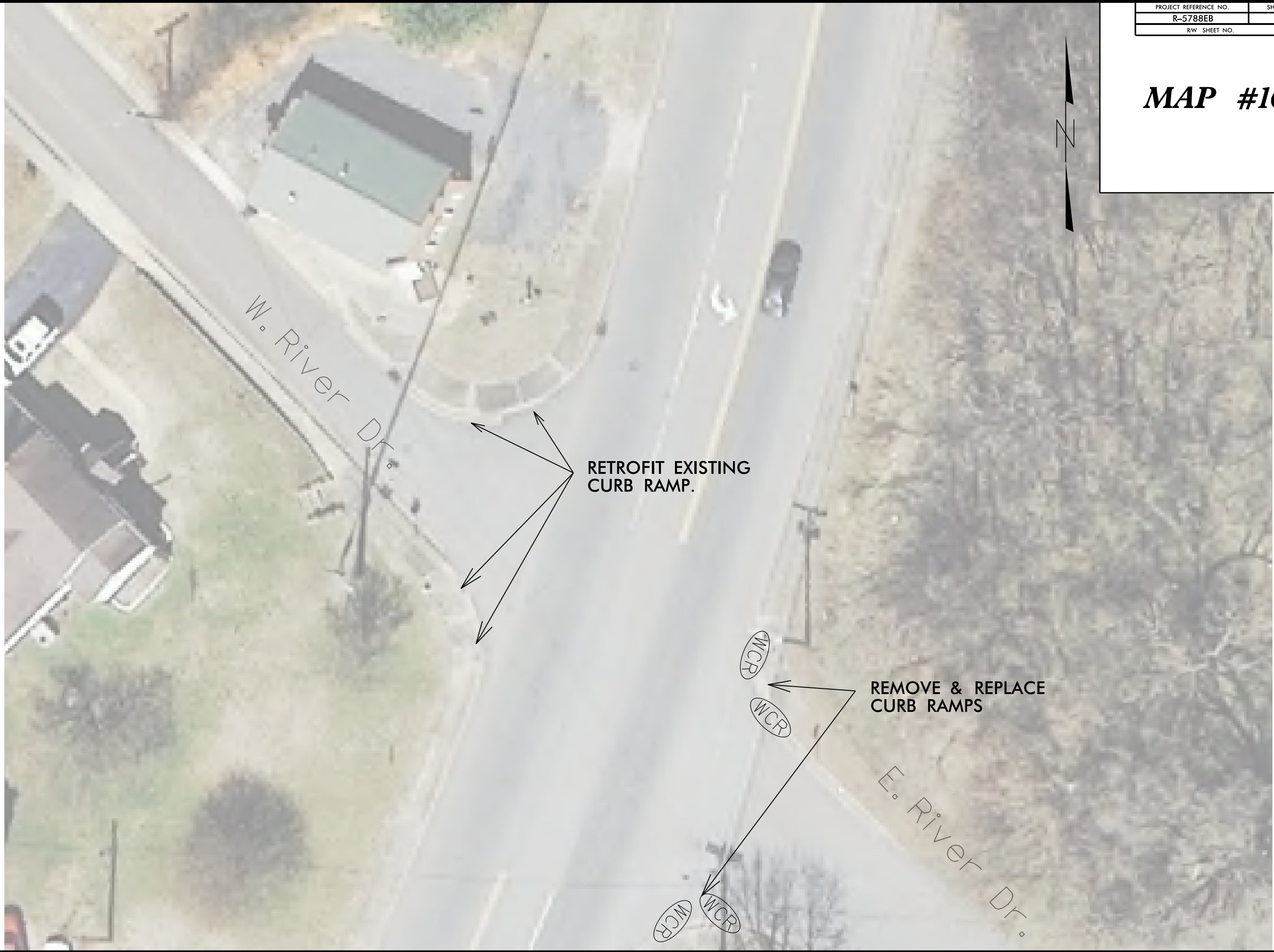
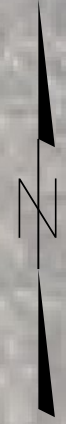

RETROFIT EXISTING CURB RAMP.

REMOVE & REPLACE CURB RAMPS

W. River Dr.

E. River Dr.

WCR
WCR
WCR
WCR

MAP #17



RETROFIT EXISTING
CURB RAMP.

Naomi St.

US 220 Bus.
(S. Main St.)

PROJECT REFERENCE NO.	SHEET NO.
R-5788EB	25
RW SHEET NO.	

MAP #18
MAP #20



NEW CURB RAMPS

RETROFIT EXISTING CURB RAMP.

NEW CURB RAMPS

SR 1006 (N. Greensboro St)

NC 49

WCR

WCR

WCR

16-OCT-2018 10:38
Z:\vd\div8\sidewalk\intersection_ramps_2019\sidewalk_int.psh\sidewalk_int-18.dgn

MAP #19



SAWCUT & REMOVE
ASPHALT PAVEMENT TO
CONSTRUCT NEW CURB RAMP.
REPLACE ASPHALT AS NEEDED
TO PROVIDE POSITIVE DRAINAGE.

MAP #21



NEW CURB RAMP

WCR

WCR

RETROFIT EXISTING CURB RAMP.

E Raleigh Ave.

NC 49

MAP #21



NEW CURB RAMP

WCR

WCR

RETROFIT EXISTING CURB RAMP.

E Raleigh Ave.

NC 49

MAP #22



MAP #23



SR 10006
(N. Greensboro St.)

W Highfall Ave.

NEW
CURB RAMPS

WCR

WCR

PROJECT REFERENCE NO.	SHEET NO.
R-5788EB	30
RW SHEET NO.	

MAP #24



W Bowman Ave.

SR 10006
(N. Greensboro St)

NEW
CURB RAMPS

WCR

WCR

PROJECT REFERENCE NO.	SHEET NO.
R-5788EB	31
RW SHEET NO.	

MAP #25



E Luther Ave.

SR 1006
(N. Greensboro St)

RETROFIT EXISTING
CURB RAMP

PROJECT REFERENCE NO.	SHEET NO.
R-5788EB	32
RW SHEET NO.	

MAP #26



W. Dameron Ave.

RETROFIT EXISTING CURB RAMP

NC 49

16-OCT-2018 10:39
Z:\dj\div\sidewalk\intersection_ramps_2019\sidewalk_int.psh\sidewalk_int_-26.dgn

PROJECT REFERENCE NO.	SHEET NO.
R-5788EB	33
RW SHEET NO.	

MAP #27



W. Patterson Ave.

RETROFIT EXISTING CURB RAMP

NC 49

16-OCT-2018 10:39
Z:\dj\div8\sidewalk\intersection_ramps_2019\sidewalk_int.psh\sidewalk_int-27.dgn

PROJECT REFERENCE NO.	SHEET NO.
R-5788EB	34
RW SHEET NO.	

MAP #28



W. Lewis Ave.

RETROFIT EXISTING CURB RAMP

NC 49

16-OCT-2018 10:39
Z:\dj\div8\sidewalk\intersection_ramps_2019\sidewalk_int.psh\sidewalk_int-28.dgn